

RECOGNIZING THE CAUSES OF PANEL PUNCH DAMAGE

**DO NOT RETURN YOUR UNIT TO THE SELLER FOR A “DEFECT IN MANUFACTURE”
IF THE DAMAGE APPEARS AS FOLLOWS:**

The Panel Punch Instructions outline the proper procedure for assembly of the Punch/Die unit in order to punch a hole. If the instructions are not followed and the Punch is inserted into the Die incorrectly, 180 degrees from its proper placement, an end load will be applied to the die section which exceeds design load and the die will break. See the example below, left. The actual load that caused this damage was not measurably higher than the force that would be required to punch 16 gauge mild steel if the punch and die were not lubricated.

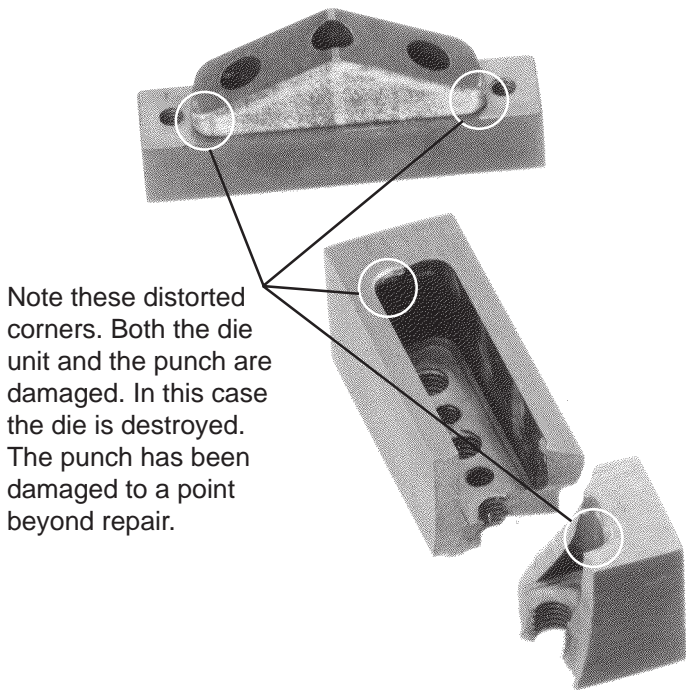

Note these distorted corners. Both the die unit and the punch are damaged. In this case the die is destroyed. The punch has been damaged to a point beyond repair.

This Punch and Die are new and undamaged. Properly used, this unit could last indefinitely.

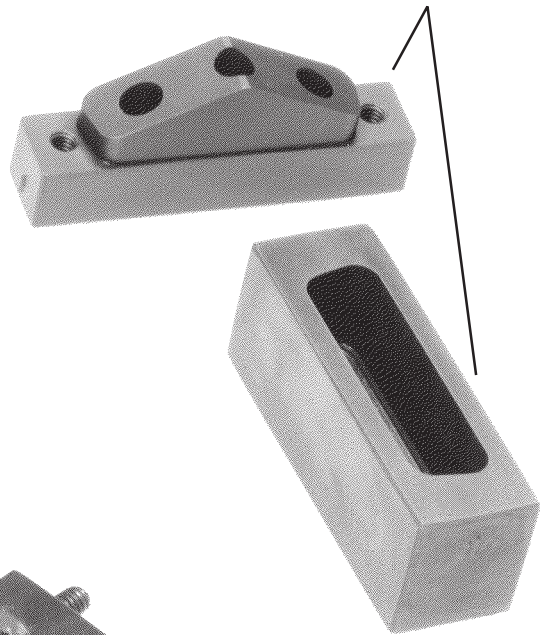

Because the Hard Point Set Screw was not retracted (backed-off; unscrewed) before the punching of subsequent holes, unequal loading of the flange occurred, resulting in breakage of the flange.

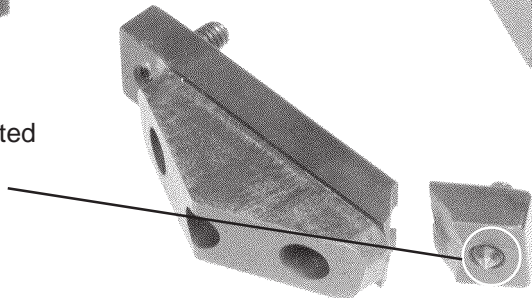

READ THE DIRECTIONS. THE ABOVE TYPES OF BREAKAGES ARE NOT COVERED BY WARRANTY.

WARRANTY AND DISCLAIMER: There are no express warranties which extend beyond the description and face hereof. SELLER DISCLAIMS ANY IMPLIED WARRANTIES AS TO MERCHANTABILITY OR FITNESS FOR ANY PARTICULAR PURPOSE. Since seller can not control the manner of use of its products after the sale, Seller will not be responsible for any consequential or indirect damages. Rather, Seller will, at it option, either replace the products sold or refund the purchase price. No warranty will apply if product is in any way altered or modified after delivery by Seller.