

# PANEL PUNCHES

for Patented

## D-Subminiature and Ribbon Connector Holes

For use with Amphenol, T & B Ansley, ITT Cannon, TRW Cinch, 3M and other connectors.  
For rear panel mounting of sockets or plugs, metal or plastic.

- Accurate punch-out conforms to plug or receptacle
- Burr free on front of panel
- Supply of adhesive backed templates included with kit
- Quality built punch/die set can be re-ground to sharpen
- Mounting holes accurately located and center-punched
- Minimal burr on rear of panel
- All necessary screws and wrenches provided with kit
- All repair parts available direct from manufacturer

Service and Laboratory Personnel cannot be without this tool because of the time and labor savings it will afford! Drill three holes and follow simple assembly steps to quickly obtain the perfect opening in 22(.025”) to 16(.051”) gauge steel and .125” maximum aluminum panel material.

### Models for D-Subminiature Connectors

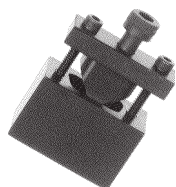

MK-9P

ACTUAL HOLE SIZES

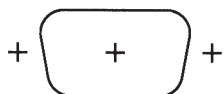

**Model MK-9P**  
for 9 pin connectors  
(RS449 Standard)

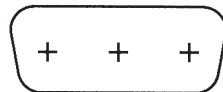

**Model MK-15P (Special)**  
for 15 pin connectors

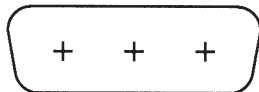

**Model MK-25P**  
for 25 pin connectors,  
(RS232 Standard)

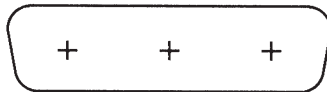

**Model MK-25PS (Special)**  
for 25 pin connectors,  
front mount metal clad connector

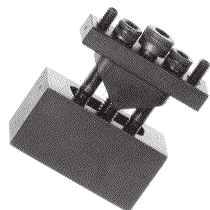

MK-15P, MK-19P

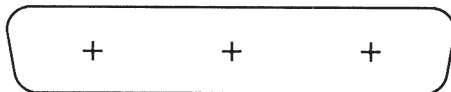

**Model MK-37P**  
for 37 pin connectors  
(RS449 Standard)

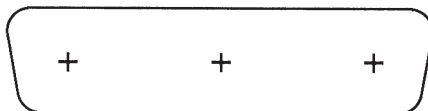

**Model MK-50P (Special)**  
for 50 pin connectors

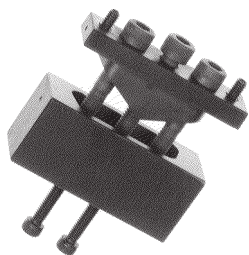

MK-25P, MK-37P,  
MK-50P

ADDITIONAL MODELS ON REVERSE SIDE

# PANEL PUNCHES

## Models for Ribbon Connectors

ACTUAL HOLE SIZES

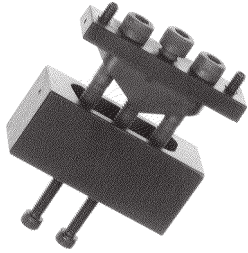

RB-24, RB-36,  
RB-50

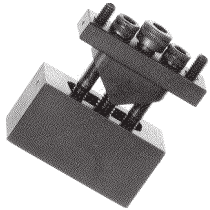
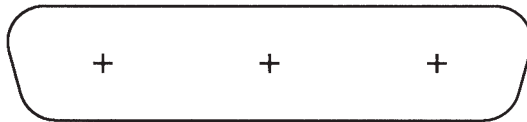
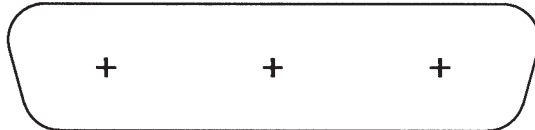
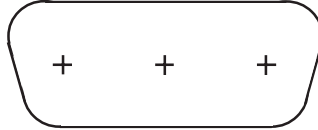
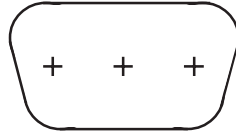

RB-14

### Model RB-14

for 14 contact connectors

### Model RB-24

for 24 contact connectors

### Model RB-36

for 36 contact connectors

(Centronics Standard)

### Model RB-50

for 50 contact connectors

(SCSI Standard)

### Model MK-50-3M (Special)

for 3M Delta Ribbon

connectors (50 contact)

## Selecting the Proper Panel Punch for D-Subminiature and Ribbon Connectors

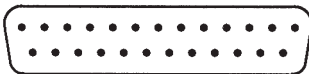

There are two families of "D" shaped connectors, the first of which is the **D-SUBMINIATURE** type. Each of these connectors is generally identified by the number of contact pins with which it is equipped. Popular standard sizes are 9, 15, 25, 37, and 50 pin units, and there is an MK series punch designed for each of these.

Note that while the mounting holes and sizes of these connectors are generally standard, the various manufacturers do not necessarily work to the same net dimensions.

The other style of connector with a "D" shaped shell is known as a **RIBBON** connector. These units have a bus type contact configuration, as opposed to the pin and socket type arrangement of the D-Subminiatures. Ribbon connectors are also generally identified by their number of contacts. The popular standards are the 14, 24, 36, and 50 contact models, and an RB series punch is available for each of these.

Also available is the MK-50-3M, a special punch used for mounting the 3M Delta Ribbon Connector.

**Our entire line of punches is designed to make the hole of sufficient size to accept the larger of either plug or receptacle, be it metal or plastic.**

MANUFACTURED BY:



**Challenge Tool & Manufacturing**

P.O. BOX 306 • 11725 LINCOLN HIGHWAY EAST • NEW HAVEN, INDIANA 46774

TELEPHONE: (260) 749-9558 • FAX: (260) 749-6724